

CALL FOR ARTISTS – REQUEST FOR QUALIFICATIONS

Bellevue Japanese American Legacy Bridge Span Mural Project (Public Art)

Deadline: **4:30pm on Monday, May 24, 2021**

Applications must be received via email by the deadline.

Table of Contents

[Project Summary](#)

[Project Conceptual Framework](#)

[BJALP Vision Statement](#)

[BJALP Mission](#)

[BJALP Goals](#)

[Conceptual Framework for this Site](#)

[Main Message for this Site \(NMZ and Bridge Span\)](#)

[Main Message for the NMZ:](#)

[Main Message for the Bridge Span:](#)

[Other heritage elements present on the Bridge Span with the mural:](#)

[Project Description](#)

[Requirements for Artist](#)

[Parameters for Artwork](#)

[Budget and Scope of Work](#)

[Application Requirements](#)

[Instructions for Submittals](#)

[Deadline](#)

[Submission Address](#)

[Artist Selection](#)

[Selection Process](#)

[Selection Criteria](#)

[Project Timeline](#)

[Additional Information](#)

[Question Period](#)

[About the Lead Organizations](#)

Attachment A: Site information

Project Summary

A community-led group based in Bellevue, WA, USA, known as the Bellevue Japanese American Legacy Project (BJALP), is seeking an artist or artist team to develop site-specific public artwork that recognizes and preserves the legacy of the Japanese American (JA) farming community of Bellevue. This community was forcibly removed from their homes and farms as a result of Executive Order 9066, issued by President Roosevelt on February 19, 1942. This order authorized specific areas within the United States as “military zones” in which Japanese Americans, regardless of their status of US citizenship were to be removed and imprisoned against their will without due process—for the duration of World War II.

This permanent artwork will be located on a new pedestrian/multi-use bridge spanning NE 8th St. in Bellevue, WA. This project is in association with a larger Eastside Rail Corridor project to convert a former rail line into a multi-use trail. At the NE 8th St. site, the bridge will also provide access to the Wilburton light rail station, currently under construction. Construction of the light rail station required the removal of a building of significance to the JA community. Given the proximity of the trail to this important historical site, the county is integrating Japanese American heritage exhibit components in several locations here: the North Mixing Zone (not addressed by this RFQ) and the Bridge Span (the purpose of the RFQ).

The selected artist will be expected to develop an artwork of appropriate scale and impact to meet the project criteria in an artistically engaging manner. This contract will be administered through project design consultants EDX Exhibits. The scope of this project is to provide a high-quality digital reproduction of original artwork created for this project which will be integrated into the site as a series of full-color, fused aluminum graphic panels visible to bikes and pedestrians crossing the bridge. The selected artist will not be responsible for physically installing any original artwork on the site.

For this artist selection process, a panel will review submitted materials from this Request for Qualifications (RFQ) and select three (3) artists who will receive a \$500 USD stipend to produce initial concepts for the project. The review panel will then share the three finalists’ work, their comments, and their recommended artist selection to the BJALP Steering Committee for final approval.

The selected final artist will work with BJALP community members, a writer, and EDX Exhibits to design artwork that embodies the project goals and concept statement, fulfills technical requirements, and meets the approval of all regulatory bodies.

Project Conceptual Framework

As one of multiple sites associated with the Bellevue Japanese American Legacy Project, this mural artwork will support and express the following vision, mission, and goals of this community organization.

BJALP Vision Statement

To honor Bellevue's Japanese American heritage through permanent, publicly accessible, and impactful commemorations that educate, engage, and unify the community.

BJALP Mission

The BJALP sites educate, have emotional and intellectual impact, and are visible and accessible to the public. Experiencing the commemorative elements, visitors are moved to feel from the heart and inspired to actively engage with their community. The commemoration sites act as a unifying force in the Bellevue community.

BJALP Goals

- Recognize the lesser-known story of Japanese American presence on the Eastside, and educate visitors about their story
- Highlight the strength and resilience of the Japanese American community
- Instill understanding of and remembrance of the Issei generation in our descendants today
- Clearly convey this story to everyone, especially to newcomers in today's culturally-diverse Eastside community
- Emphasize that this is an American story, and communicate its relevance, today and in the future

Conceptual Framework for this Site

The following concepts and messages have been developed for this site, which includes two locations: the North Mixing Zone (NMZ)—not part of this RFQ, and the Bridge Span—the purpose of this RFQ.

Main Message for this Site (NMZ and Bridge Span)

Recalling the roots from our past, telling silenced stories, and recognizing the harms that were done here are necessary to create our flourishing future.

Main Message for the NMZ:

This site has a focus on the story of the packing house and what it represented—the agricultural story and community.

Main Message for the Bridge Span:

The concept of *kakehashi*—bridge building—represents how sharing stories fosters connection.

By telling the story of the JA farming community in Bellevue, we:

- strengthen the connections between the Japanese American community and other communities,
- see Bellevue’s vibrant farming history in today’s modern metropolis,
- plant the seeds of reconciliation across generations, and
- honor stories of the past today, and for the future.

Project Description

Requirements for Artist

Artists may respond to this solicitation if they meet the following qualifications:

1. Be based locally to the project site in the Pacific Northwest (there is no additional budget for transportation to the site or for meetings)
2. If an artist team, be willing to accept payment to one source (we are unable to arrange for separate payments within a team)
3. Have experience or knowledge with the subject matter of JA history in Washington State

Parameters for Artwork

The successful completed artwork should:

4. have a simple, powerful message;
5. be specific to the Japanese American story in Bellevue, but with universal connections, showing sensitivity to other groups who have lived in this place or for whom this place is their homeland;
6. generate strong emotional responses from viewers;
7. be eye-catching to viewers entering the bridge span and moving across the bridge at varying speeds—biking, walking, and running. Visitors to this artwork will be in motion themselves and will need to remain aware of other trail users approaching from both directions;
8. be integrated into the site and the other features of the bridge and the site including the heritage elements in the North Mixing Zone;
9. be provided as high-resolution digital artwork by the artist for reproduction on 2D (flat) full-color fused aluminum panels; and
10. rely on existing bridge lighting and not include any additional electrical infrastructure.

Artists are encouraged to consider that the site is located on a multi-modal trail accessed by people of all ages, abilities and backgrounds. The artwork must be suitable for diverse audiences.

Attachment A, providing additional reference material, is included at the end of this document.

Budget and Scope of Work

A total of up to \$20,000 USD has been secured for the selected artist for this scope of work. This budget is all-inclusive of artist fees and will be dependent on the size and complexity of the selected work. The selected final artist's scope of work will include, but not be limited to, the following:

- Review of project criteria as well as requirements and regulations;
- Iterative development of the artist's design, working with the community-led project committee, community stakeholders, a writer, and EDX Exhibits;
- Making presentations to the project team;
- Integrating the artwork with text elements and graphic panels that may accompany the artwork on the bridge span;
- Adhering to project schedules;
- Delivery of print-ready art as .tif, .jpg, RAW or other approved image format at the specified size and resolution;
- Understanding that the artwork will be reproduced as a full-color graphic on a series of fused-aluminum panels spanning the bridge overpass at NE 8th St. in Bellevue;
- Review of graphic production files with integrated artwork, to be produced by EDX Exhibits for fabrication and installation;
- Understanding that the artist is not responsible for materials, printing, and installation of the printed art, which will be handled by the bridge construction team under their budget; and
- Acceptance of installment payments in USD by check. If a fee-based payment method such as PayPal is requested for payment, fees incurred by the payee will be taken out of the total project budget listed above.

Application Requirements

Instructions for Submittals

Applicants are required to apply via electronic submittal. Either send materials via email to artist.call@edxseattle.com or use Dropbox, Google Drive, or any other shared cloud file storage service. If applying via Dropbox or other, upload all materials in one folder labeled “NE8th Bridge Project_artist’s last name” and share the folder with artist.call@edxseattle.com.

This Call is open to any artist or artist team based in Western Washington State, USA. Please submit:

- Letter of Interest (500 words or less) that describes why this opportunity is of interest, your general approach to the artwork site and context, and relevant skills brought to this project
- Digital work samples – applicants may submit at least three (3) and up to five (5) images that clearly show past projects, work experience, and experience with themes associated with Japanese American heritage.
 - Files should be prepared as .jpg files only, suitable for high-quality viewing on screen. They do not need to be print resolution.
 - Files should each contain a single image and be labeled “01BridgeProject_ last name, 02BridgeProject_ last name”, etc.
 - Total size of files and associated application materials, whether emailed or submitted via a cloud sharing application, must be less than 15MB.
- Annotated image list – this list of images must include the budget, project year and duration, location, client or commissioning agency, title, media, and a brief description (50 words or less) of the applicant’s role in the project
- Resume – listing comparable projects, artwork exhibitions, and any other relevant experience, two pages maximum
- 3 references including email and phone contact information, who can speak to the project examples provided in this response.

Deadline

Required materials must be received by email no later than **4:30pm on Monday, May 24, 2021**. Applications must be received by the deadline. We will not review incomplete or late submissions.

Submission Address

Please send submissions to: artist.call@edxseattle.com

Please use “NE 8th St. Bridge Project” in the email subject line for your submission’s consideration.

Artist Selection

Selection Process

1. A review panel composed of community representatives, project stakeholders, and arts professionals will select up to three (3) finalists to submit proposals.
2. Finalists will be notified of their status on the date specified below.
3. Finalists that are chosen to present concept proposals will be provided with a digital slideshow of the site renderings, basic messages to be communicated on the bridge span, and project orientation via Zoom prior to their submittal.
4. Finalists will have three weeks to complete the concept and will make a presentation to the selection committee on **July 6, 2021**.
5. Each finalist will be compensated in the amount of \$500 USD after developing and presenting a concept for the bridge span mural.
6. The review panel will then review the finalist concepts and recommend a final artist to the project Steering Committee. The review panel and Steering Committee reserve the right to not select any artists, if they so choose.
7. Contracting and work on the Bridge Span mural will commence immediately following artist selection.

Selection Criteria

Selection criteria for finalists will be based on:

- A. quality of past work;
- B. familiarity and experience with the subject matter;
- C. demonstrated ability to coordinate and collaborate with project managers, design team, and community stakeholders
- D. demonstrated ability to complete projects of similar scale and context; and
- E. demonstrated ability to complete projects on time and on budget.

The final artist will be selected based on the above listed criteria as well as the strength in:

- F. the design concept;
- G. alignment with project mission, vision, and goals;
- H. understanding of the significance and meaning of the project and its historical context in the area; and
- I. appropriateness of the solution for the site and setting.

Project Timeline

Date	Event
April 23, 2021	Open call to artists circulated
May 10, 2021	Question period ends All responses emailed/posted with original solicitation materials by EOD May 14
May 24, 2021	Submissions due, 4:30 pm PDT
June 08, 2021	Finalists notified
June 09-11, 2021	Digital site tour and Q&A via Zoom (specific date to be coordinated)
July 02, 2021	Selected finalists submit concepts
July 06, 2021	Selected finalists present concepts to jury panel via Zoom
July 07, 2021	Selection panel meets to select final artist
July - Aug, 2021	First draft development and review
Sept - Oct, 2021	Second draft development and review
November 2021	Final design complete

This project must be completed in full by November, 2021 to meet project deadlines associated with site infrastructure.

Additional Information

Question Period

Questions will be answered during the question period. Please submit questions in writing by May 10, 2021 to artist.call@edxseattle.com

Responses to questions will be emailed to those who responded with questions. The call for artists will also be updated with an additional website link by EOD May 14, 2021.

About the Lead Organizations

Bellevue Japanese American Legacy Project (BJALP) is an effort to honor the legacy of Bellevue's Japanese American community prior to WWII, and tell the story of Japanese American incarceration from 1942-1944 and its impacts on the Bellevue community. BJALP maintains a steering committee, a community advisory committee, and a site search committee engaged in identifying significant locations within Bellevue to tell this story. In 2019, BJALP became aware of the efforts at the NE 8th St. Bridge Crossing project and this effort is part of the resulting heritage exhibits planned for that site.

EDX Exhibits is a collaborative of 2d- and 3d designers, writers, strategists, and planners based in Seattle, Washington. We help museums, organizations, businesses, and parks to engage thousands each year, from the fjords of Alaska to Puerto Rico's historic forts, inspiring people from all walks of life to connect with the story and place. At EDX, broad-minded creativity and interpretive strategies are closely aligned. Our practice weaves together design contributions across disciplines and media to create seamless, multi-sensory exhibit experiences. Our finished projects connect with audiences in a direct and personal way, creating environments where curiosity is rewarded and learning happens naturally. Our capabilities include interpretive planning, master planning, exhibit design, and interpretive content development, among others. Learn more about EDX at www.edxseattle.com.



NE 8th St. Bridge Project
JA Heritage Installation:
Bridge Span

Call for Artists: Attachment A

April 23, 2021



200 East Boston Street, Seattle, WA 98102 | www.edxseattle.com

Table of Contents

- 3 NE 8th St. Crossing Project Site
- 4 Bridge Span Drawings and Renderings
- 8 Additional Project Information



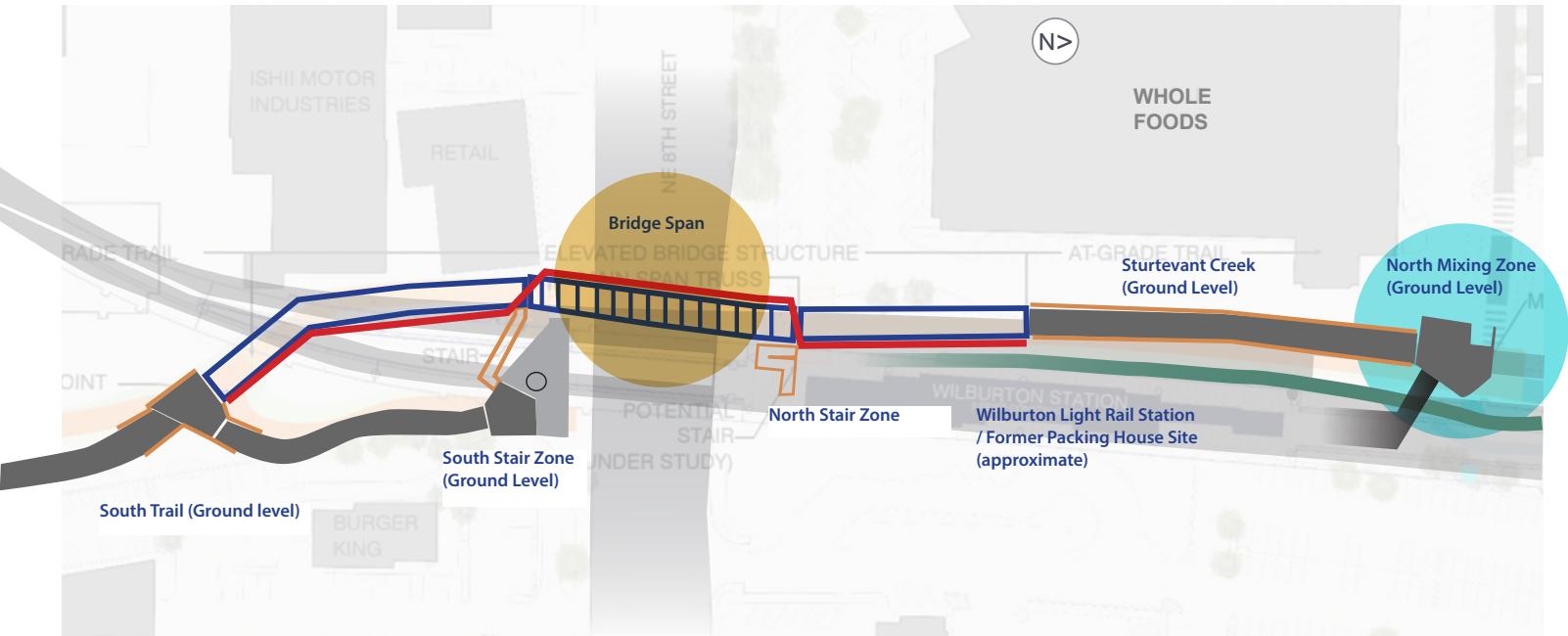

NE 8th St. Bridge Crossing Project Site



Project Site

The entire NE 8th St. Bridge project is depicted schematically above. Locations of Japanese American Legacy Project site components are indicated with bubbles:

-  Bridge Span components associated with this RFQ
-  North Mixing Zone components in the project but not part of this RFQ

Site Plan: Bridge Span

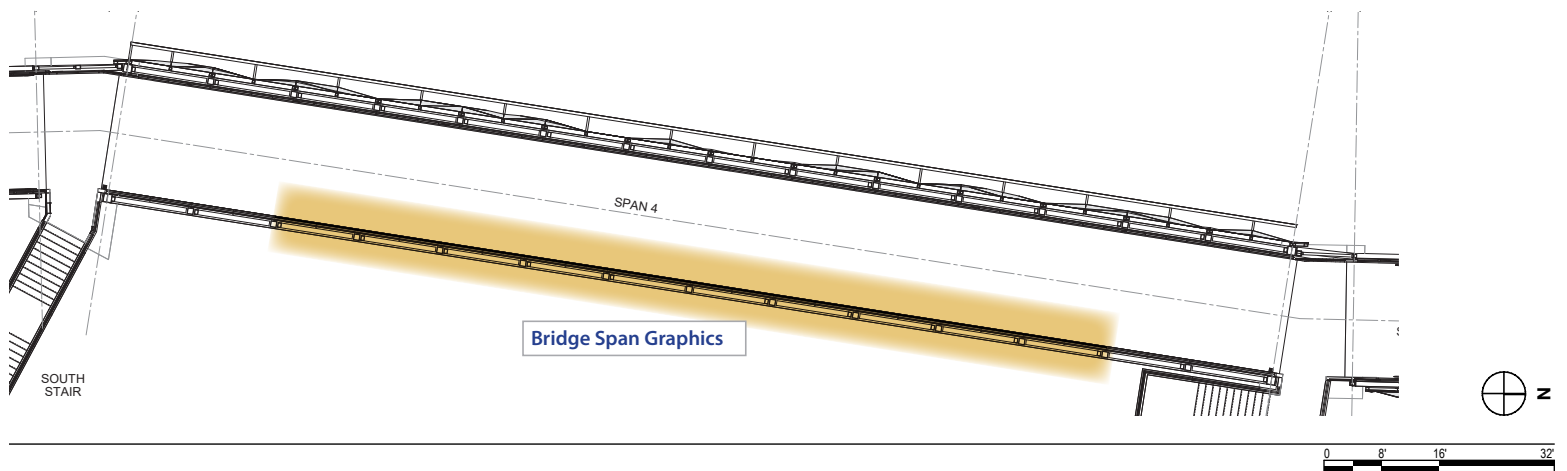

Artwork Site and Location

This permanent artwork will be located on the east side of a steel truss structure that covers a pedestrian bridge spanning NE 8th St. in Bellevue, WA. The space available for a combination of mural art and text is an area that is 121' wide x 6' high, and is viewed while crossing the bridge on the multi-use pathway. Behind the wall comprising the mural is an expanse of concrete that supports the Wilburton light rail station. The station parallels the east side of the bridge. An active roadway is located beneath the bridge. The bridge connects to sections of the Eastrail on either side, and stairs provide access to the light rail station.

Due to maintenance constraints, the artwork must rely on the existing bridge lighting and cannot include any additional electrical infrastructure. The wall containing the mural artwork will not be illuminated directly, but will benefit from lighting integral to the bridge overpass truss.

Elevations: Bridge Span

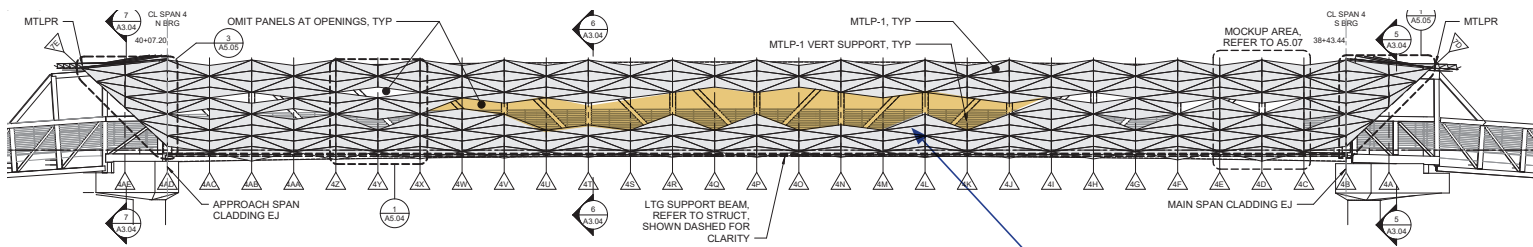
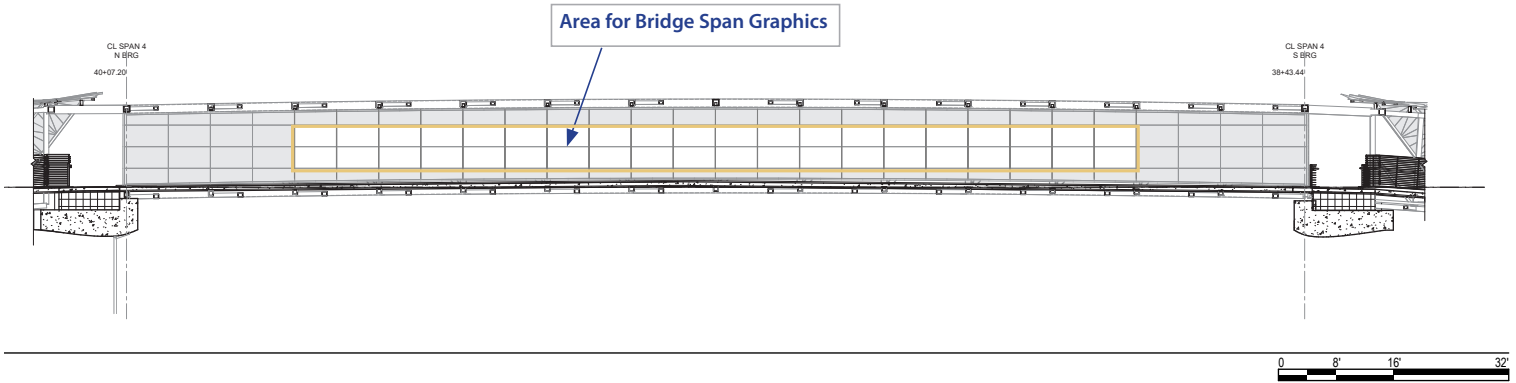

4 SPAN 4 WEST ELEVATION
Scale: 1/16" - 1'0"

Area of panels that show through the bridge cladding (from street view)

Renderings: Bridge Span



For position only artwork to show approximate location on bridge span

Renderings: Bridge Span



Bridge as viewed from NE 8th St.

Additional Project Information: Materials / Bridge Span

The art for the bridge span will be reproduced on fused aluminum panels that are engineered to attach to existing infrastructure on the bridge. An example of the material to be used is below.



Additional Project Information: North Mixing Zone

The project goals require Japanese American content contributors to collaborate with the exhibit design team on key components of the design. At this time, the content contributors on this page have been selected for a defined scope of work in the North Mixing Zone.

Lauren Iida



Role on this project

- Lauren will create a large representation of motifs that symbolize the JA story in Bellevue on the west side of the North Mixing Zone.
- Her work will be expressed as full color graphic panels and in cut metal as fencing.

Akiko Sogabe



Role on this project

- Aki will create a large representation of the packing house and historical farming scenes on the east side of the North Mixing Zone.
- Her work will be expressed as a cut metal triptych with back-lighting.

Lawrence Matsuda



Role on this Project

- Larry will create exhibit text in the form of poetry and narrative copy for the North Mixing Zone and the Bridge Span